

LEDDriving SL PS19W

Ideal replacement for any vehicle



Suitable for various vehicle exterior applications

Available in Cool White



Replaces conventional PS19W lamps

Easy upgrade to LED technology with plug & play solutions

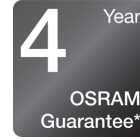

Reliable OSRAM quality stands for less lamp replacements

4-year OSRAM guarantee (refer to www.osram.com/am-guarantee for precise conditions)



Suitable LED replacement for PS19W

LEDDriving SL PS19W replacement lamps offer a modern and intense light with a color temperature up to 6,000 Kelvin. These replacement lamps are suitable for all conventional PS19W lamp bases. In comparison to standard lamps, these LED retrofit lamps use up to 80% less energy. OSRAM offers a 4 year guarantee for these LEDDriving SL lamps. These products do not have ECE approval and must not be used on public roads in any exterior application. Public roads use leads to cancellation of operating license and loss of insurance coverage. Several countries forbid sale and use of these products. Please contact your local distributor for further information.

Product datasheet

Technical data

Product information

Product type (off-road vs. on-road)	Off-road \triangleq PS19W
Application (Category and Product specific)	Mainly used for daytime running light applications

General Product Information

Global order reference	5201DWP
------------------------	---------

Electrical Data

Power input	1.8 W
Nominal voltage	12.0 V
Nominal wattage	1 W
Test voltage	13.5 V
Power input tolerance	± 10 %

Photometric Data

Nominal luminous flux	140 lm
Luminous flux tolerance	± 25 %
Color temperature	6000 K
Light color LED	Cool white

Physical Attributes & Dimensions

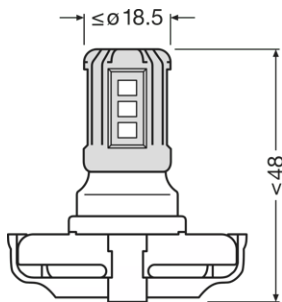

Diameter	15.5 mm
Product weight	11.00 g
Length	42.5 mm
Lamp base	PG20-1

Lifetime Data

Product datasheet

Lifespan B3	1500 hr
Lifespan Tc	4000 hr
Guarantee	4 years

Capabilities

Technology	LED ¹⁾
------------	-------------------

¹⁾ Light-emitting diode lamp

Environmental & Regulatory Information

Information according Art. 33 of EU Regulation (EC) 1907/2006 (REACH)	
Primary article identifier	4062172150293 4062172401456
Candidate list substance 1	Lead
CAS No. of substance 1	7439-92-1
Safe use instruction	The identification of the Candidate List substance is sufficient to allow safe use of the article.
Declaration no. in SCIP database	11589200-5e74-464c-a970-2b1ae6f9e2dc

Logistical Data

Product code	Product description	Packaging unit (Pieces/Unit)	Dimensions (length x width x height)	Volume	Gross weight
4062172150293	LEDiving SL \triangleq PS19W	Folding carton box 1	34 mm x 34 mm x 58 mm	0.44 dm ³	14.00 g
4062172150309	LEDiving SL \triangleq PS19W	Shipping carton box 10	178 mm x 76 mm x 67 mm	0.91 dm ³	171.00 g
4062172401456	LEDiving SL \triangleq PS19W	BLI ECO 1	95 mm x 34 mm x 135 mm	0.44 dm ³	21.00 g
4062172401463	LEDiving SL \triangleq PS19W	Shipping carton box 10	194 mm x 144 mm x 110 mm	3.07 dm ³	270.00 g

The mentioned product code describes the smallest quantity unit which can be ordered. One shipping unit can contain one or more single products. When placing an order, for the quantity please enter single or multiples of a shipping unit.

Download Data

File
 Brochures LEDiving Retrofits - Exchange overview (EN)

Safety advice

Product datasheet

Canbus compatible Coloured lamps for usage behind coloured glass

Legal advice

These products do not have ECE approval and must not be used on public roads in any exterior application. Public roads use leads to cancellation of operating license and loss of insurance coverage. Several countries forbid sale and use of these products. Please contact your local distributor for further information.

Application advice

For more detailed application information and graphics please see product datasheet.

Disclaimer

Subject to change without notice. Errors and omission excepted. Always make sure to use the most recent release.

The OSRAM logo is displayed in a bold, orange, sans-serif font.